

Cross Arm/Straight Arm Post

Assembly Instructions

Hardware included:
2 white plastic screw covers
1 black rubber washer
3 U shaped clips

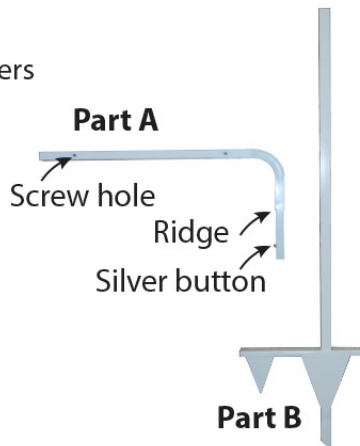
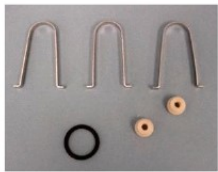

Step 2:

Insert the U clips through the top of the sign then squeeze the clip and insert into holes on the underside of Part A. There are four holes to use depending on the sign width.

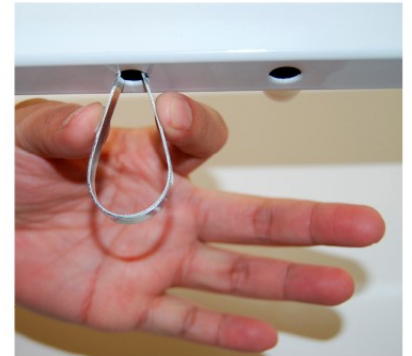
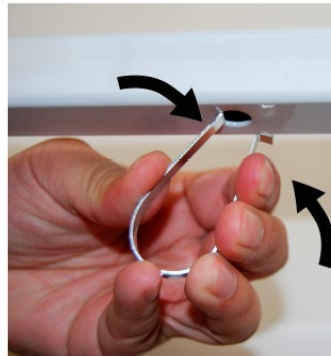
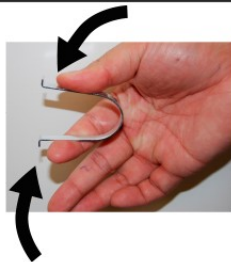

squeeze the clip's ends together to insert into hole

Step 3:

Part B also has 2 holes that the third U clip can be used to help hold the sign in place.



Step 4:

Screw white plastic covers into screw holes on Part A to hold a sign rider (sign sold separately)

